

DRAUFSICHT Schalungsstein

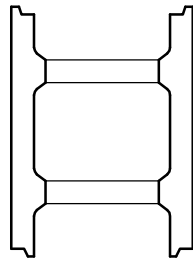

ANSICHT

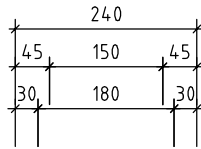
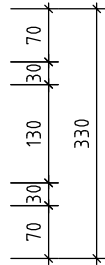

ANSICHT Schalungsstein

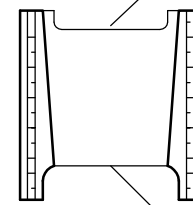
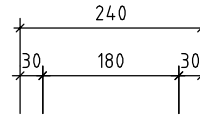

Aussparungsgröße
ca. 35 cm²

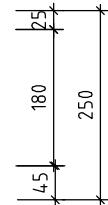

Aussparungsgröße
ca. 75 cm²

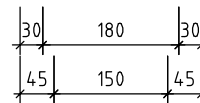

DRAUFSICHT Endstein

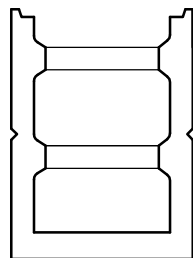
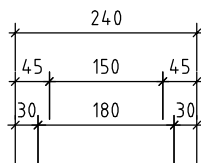

ANSICHT

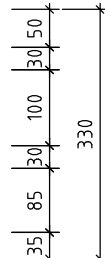

ANSICHT Endstein

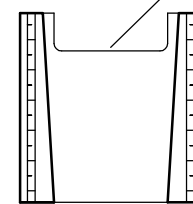
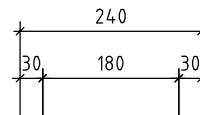

Aussparungsgröße
ca. 75 cm²

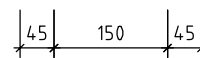
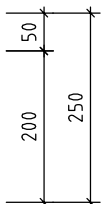

Abmessung b/l/h mm	240/330/250
Druckfestigkeit in N/mm ²	≥ 20
Rohdichte in kg/dm ³	1,4
Stück/Pal.	64
kg/Stück	16,5
Stück/m ²	12
Stück/m ³	50
Betonbedarf in l/m ²	150

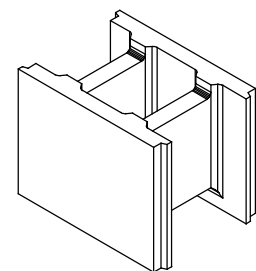

3d- Bild

Hersteller : Betonwerk Martin Hansky Crostwitzer Straße 1 01920 Höflein	Plan : Draufsichten und Ansichten Stein 24 cm	Maßstab : 1:10
	DIPL.-ING. ROBERTO KORENG INGENIEURBÜRO FÜR TRAGWERKSPLANUNG	
	Prielitzer Straße 2d D-01920 Elstro OT Kriepitz	Tel.: 03 57 93 / 4 57 30 Fax: 03 57 93 / 4 57 31